

## Interference Check for Structural System in Revit Structure

**Problem:** When running a clash detection in Navisworks model, it shows a million clashes in the models imported from Revit Architecture, Structure and MEP. Maximum part of these clashes are very minor like a joist overlapping a beam or a truss system. It becomes a tedious process for the CM to analyze and report each and every minor clash.

**Solution:** To prevent Navisworks from showing too many minor clashes in a structural model, the Revit Structure has a command called Interference check. This command checks for minor clashes like the one mentioned above, thus, avoiding showing too many clashes in Navisworks and using it to find interdisciplinary clashes like structural - mechanical.

Here is the procedure to perform interference check in Revit Structure 2012.

1

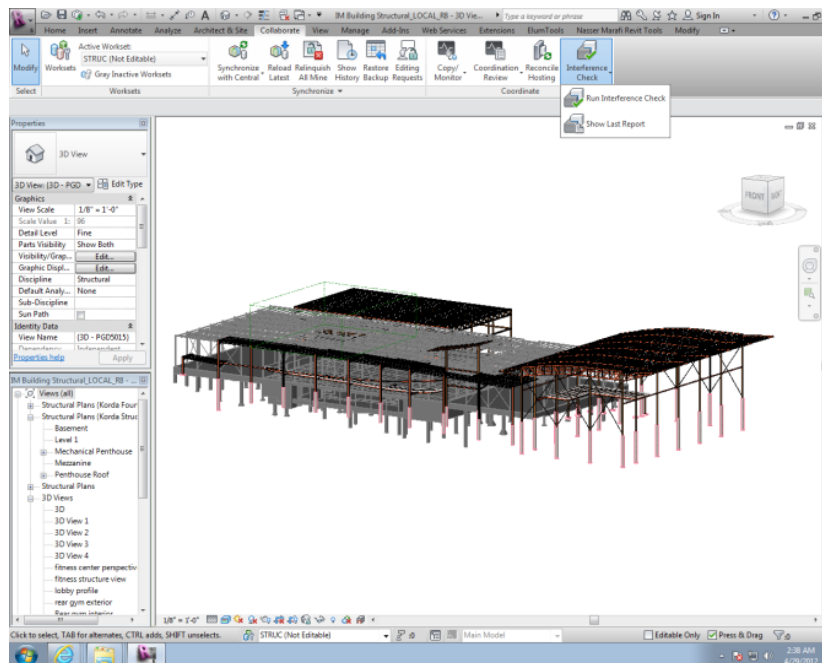

Open the revit model in 3D view. Click on Collaborate tab → Run interference check.

2

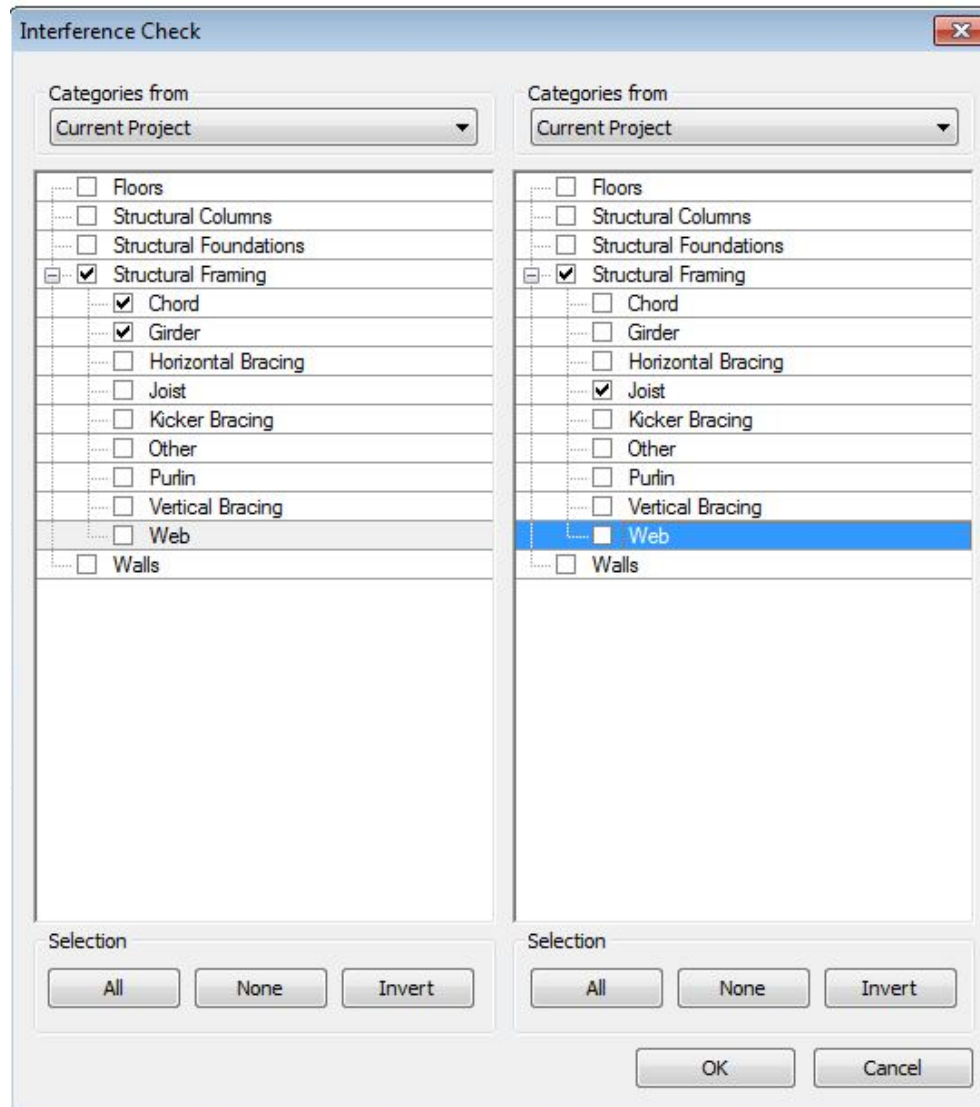

In the interference check dialog box, the element on left is checked for interference with element on the right. In the example, we decided to check the interference of a truss girder with joists in space.

4

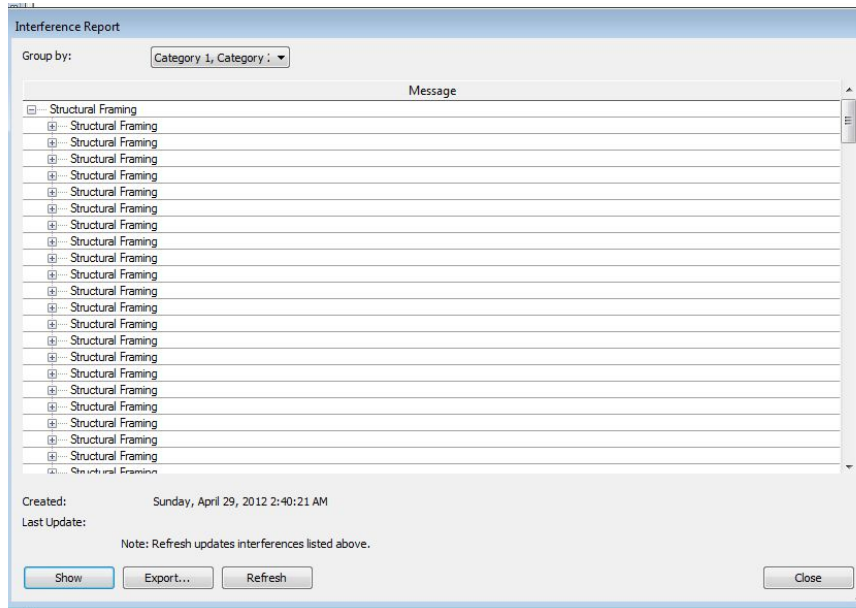

As you process the information, the above screen will be viewed.

5

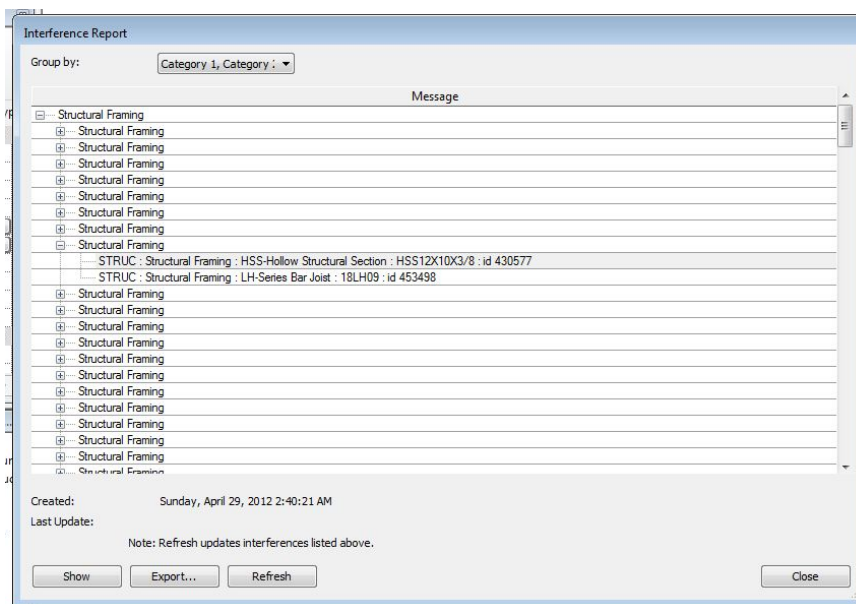

Select one of the interferences to see if in the structure model and click export to report

matter.

6

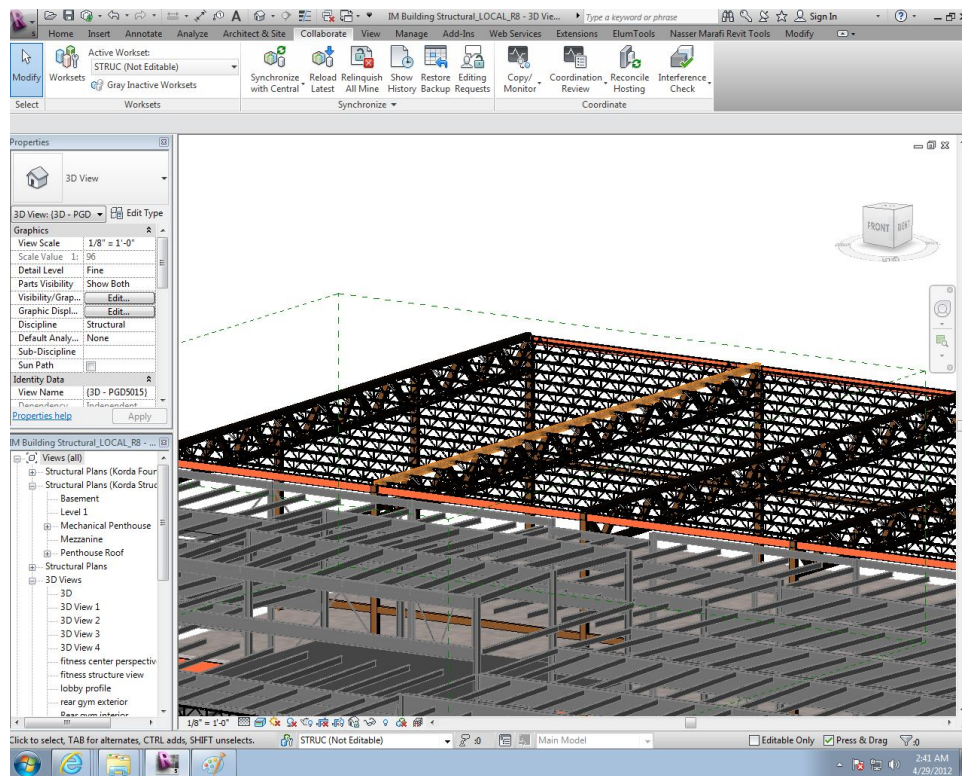

3D view, so that the interference can be seen more realistically.

7

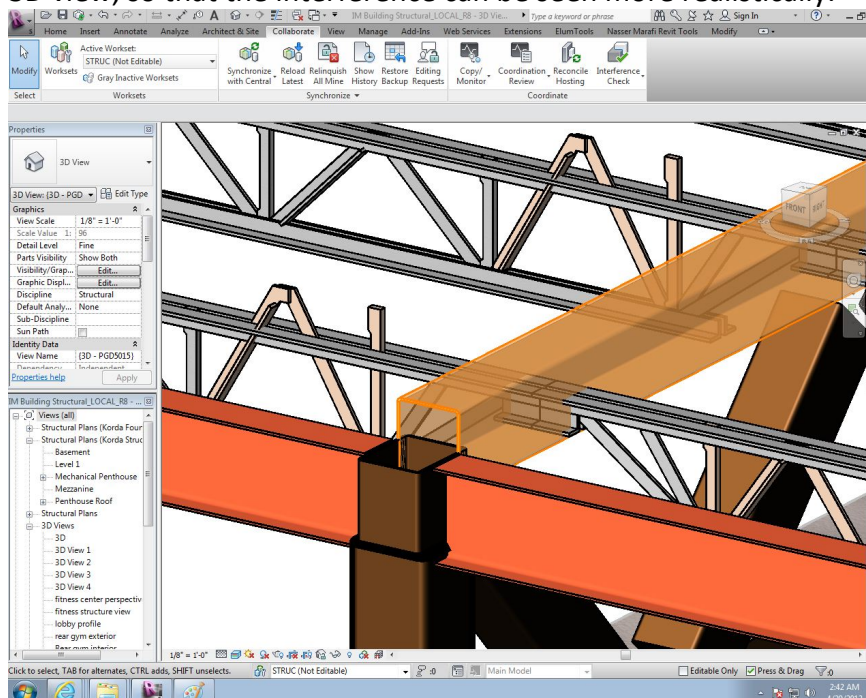

As an example, you can see the intersection of top chord of the truss system overlapping the column.



Interference Report Project File: \\csla-sala-odmsrv.sala.psu.edu\BIM\_Studio\_2012\05\_Team7\_Structural\Revit files\IM Structural New\IM Building Structural\_LOCAL\_R8.rvt  
Created: Sunday, April 29, 2012 2:40:21 AM  
Last Update:

[illegible]

In the end, you can export an interference report to excel.